



Flexwound®
metallic and semi metallic gaskets



FMI is an Italian manufacturing company specialised in the processing of PTFE, graphite and all the main asbestos-free materials used for the production of gasketing materials gaskets and semi finished products of high technical value.

The company's current structure has resulted from progressive developments over the years which have led to the engineering of unique processing and manufacturing methods.

FMI manufactures leading-edge products and innovative solutions which are protected by international patents.

FMI's underlying goal is to provide the best quality, as certified by all major independent examination institutes.

Our products are our best guarantee suitable for all types of customers and applications, both standard and critical.

For a detailed list of the approvals, please visit our dedicated area on www.fmi-spa.com/approvals



FMI metallic gaskets are specifically designed to withstand extreme temperatures and pressures, combined with chemical exposure. Available in unlimited combination of metals and filler materials and in a variety of different styles. FMI metallic gaskets are manufactured in accordance with international standards (Asme, Din, En, BS and many others) and can also be produced as a customized solution in order to meet customers demand.

APPLICATIONS

Power Station
Heat exchangers
Boilers
Chemical plants
High pressure pipe lines.

FLEXWOUND® SPIRAL WOUND GASKETS

TYPES

GRI

The standard version is the Style GRI spiral wound gasket with inner and outer ring. This gasket has the best sealing characteristics combined with the highest safety for flanged joints with flat face and raised face flanges.

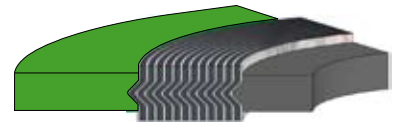

GR

By means of suitable dimensioning of the centering ring, the sealing element is accurately centered on the flange face by the bolts. A general purpose gasket for use with flat face and raised face flanges.

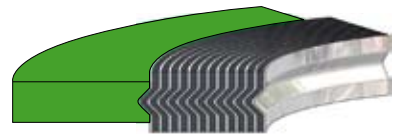

RR

Style RR spiral wound gasket with no accessory ring is suitable for tongue and groove applications and for operation with a compression stop. Given a gasket thickness of 4.5 mm, a groove depth of 3.3 (\pm 0.1) mm is recommended to provide the compression stop.



RI

Style RI spiral wound gasket with inner ring is designed specifically for male and female flanges, the inner ring providing radial confinement to prevent blow-out of the spiral element.

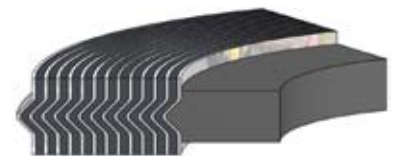

GUIDE RING COLOR CODING

FMI color coding meets the industry standard for metal and filler materials listed in ASME B16.20.

METALLIC WINDING MATERIALS

Solid color around the outside edge of the guide ring.

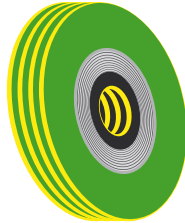

304 SS
YELLOW

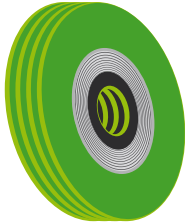

316L SS
GREEN

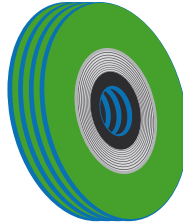

321 SS
TORQUOISE

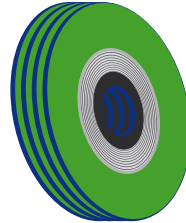

347 SS
BLU

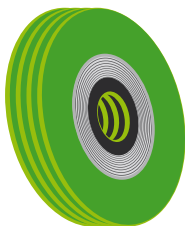

310 SS
NO COLOR

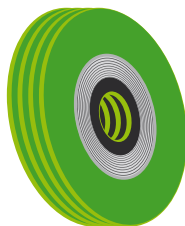

304L SS
NO COLOR

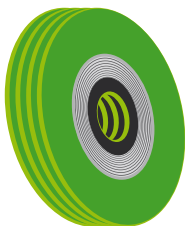

309 SS
NO COLOR



430 SS
NO COLOR

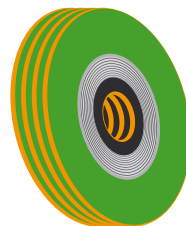

Monel®
ORANGE

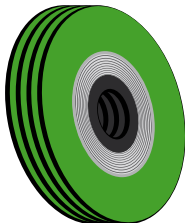

Alloy 20
BLACK

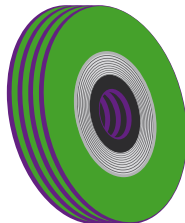

Titanium
PURPLE

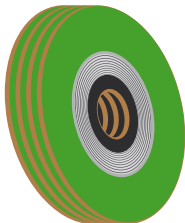

Inconel®
600/625
GOLD



Incoloy®
800/825
WHITE



Inconel®
X750
NO COLOR

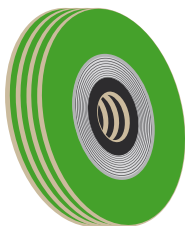

Hastelloy® C276
BEIGE

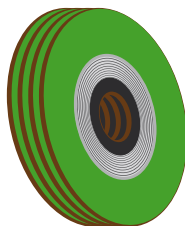

Hastelloy® B2
BROWN

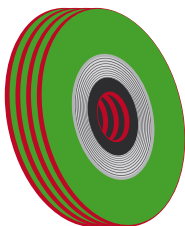

Nickel 200
RED



Zirconium
NO COLOR

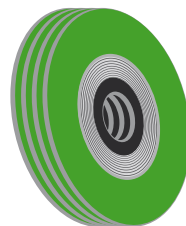

Carbon Steel
SILVER

NON METALLIC FILLERS

Alternated color strips placed at equal intervals around the outside edge of the outside ring.

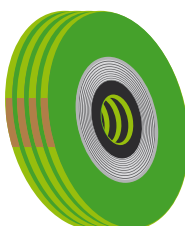

Micatherm
GOLD STRIPE



PTFE/Sichem®
WHITE STRIPE

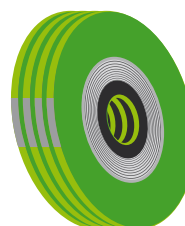

Flexigraf®
GRAY STRIPE



Bio Ceramic
LIGHT GREEN STRIPE

AVAILABLE GASKET MATERIALS

METAL WINDING STRIP

STANDARD

STAINLESS STEEL
TYPE 316 L
TYPE 304

OTHERS

STAINLESS STEEL
304 L
309
310
316 TI
321
347
430
410
ALLOY 20
MONEL®
TITANIUM®
NICKEL®
INCONEL® 600
INCONEL® 625
INCONEL® X-750
HASTELLOY® B2
HASTELLOY® C276
INCOLOY® 800
INCOLOY® 825
DUPLEX
SUPER DUPLEX
ZIRCONIUM®
TANTALUM®
COPPER
PHOS-BRONZE
CARBON STEEL

FILLER MATERIAL

STANDARD

FLEXIGRAF®

OTHERS

MICATHERM
SICHEM®
PTFE
BIOCERAMIC

GUIDE RING MATERIAL

STANDARD

CARBON STEEL

OTHERS

STAINLESS STEEL
TYPE 316 L
TYPE 304
304 L
309
310
316 TI
321
347
430
410
ALLOY 20
MONEL®
TITANIUM®
NICKEL®
INCONEL® 600
INCONEL® 625
INCONEL® X-750
HASTELLOY® B2
HASTELLOY® C276
INCOLOY® 800
INCOLOY® 825
DUPLEX
SUPER DUPLEX
ZIRCONIUM®
TANTALUM®
COPPER
PHOS-BRONZE

Materials should be selected with regard to operating temperature and chemical compatibility. If in doubt, contact

FMI Technical Department.

ASME B16.20 API STAMPING REQUIREMENTS

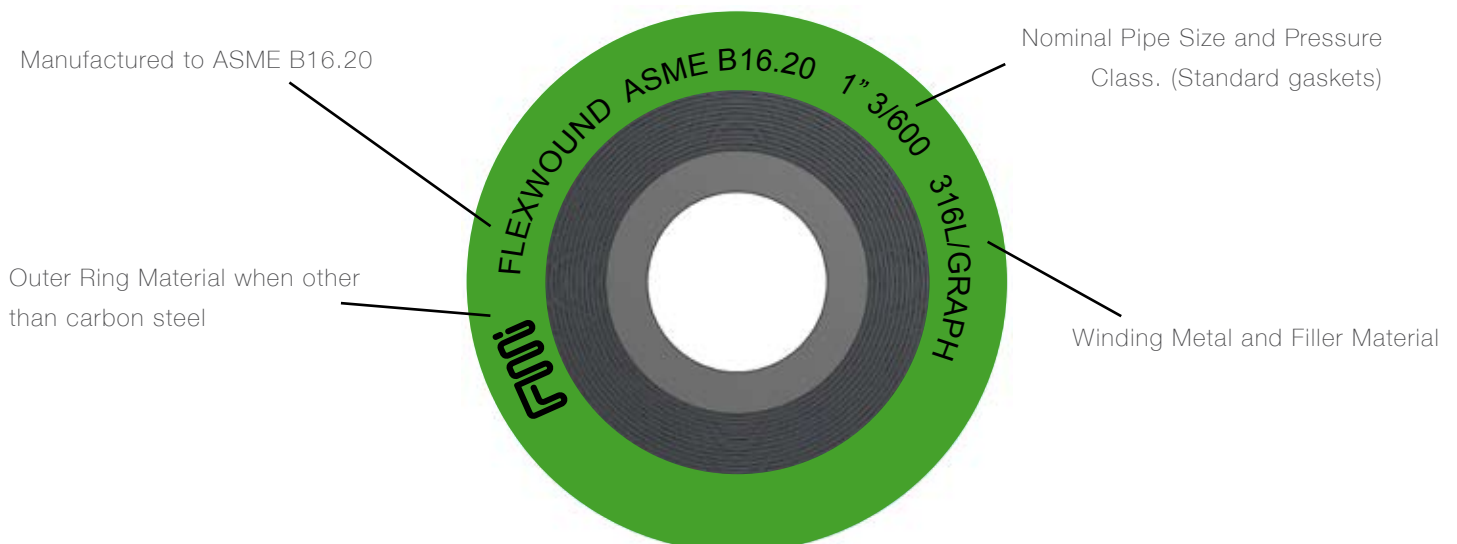

DIMENSIONAL DATA STYLE GR AND GRI TO ASME B16.20 TO SUIT ASME B16.5 FLANGES

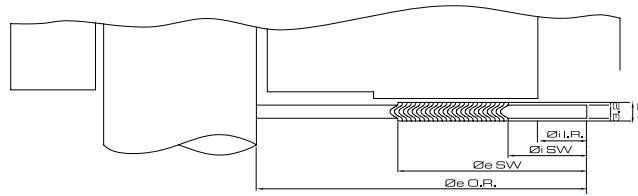

		1/4"			1/2"				3/4"				1"				
ASA	Øi I.R.	Øi SW	Øe SW	Øe OR	Øi I.R.	Øi SW	Øe SW	Øe OR	Øi I.R.	Øi SW	Øe SW	Øe OR	Øi I.R.	Øi SW	Øe SW	Øe OR	
150								47,8				57,2				66,8	
300	X	12,7	22,2	44,5	14,3	19,1	31,8	54,1	20,6	25,4	39,6	66,8	27	31,8	47,8	73,2	
400	X							63,5				69,9					79,5
600	X							69,9				76,2					85,9
900		XXX															
1500		XXX															
2500		XXX															

		1 1/4"				1 1/2"				2"				2 1/2"			
ASA	Øi I.R.	Øi SW	Øe SW	Øe OR	Øi I.R.	Øi SW	Øe SW	Øe OR	Øi I.R.	Øi SW	Øe SW	Øe OR	Øi I.R.	Øi SW	Øe SW	Øe OR	
150				76,2	44,5	54,1		85,9	55,6	69,9		104,9	66,7	82,6		124	
300	38,1	47,8	60,5	82,6	41,3	47,8	69,9	95,3	52,4	58,7	85,9	111,3	63,5	69,9	98,6	165,1	
400				88,9				98,6				143					165,1
600				104,9				117,6				146					168,4
900																	
1500	33,4	39,6															
2500																	

		3"				3 1/2"				4"				4 1/2"					
ASA	Øi I.R.	Øi SW	Øe SW	Øe OR	Øi I.R.	Øi SW	Øe SW	Øe OR	Øi I.R.	Øi SW	Øe SW	Øe OR	Øi I.R.	Øi SW	Øe SW	Øe OR			
150	81,3			136,7	102,6*	114,3		161,9	106,5	127		174,8	128*	139,7		177,8			
300		101,6	120,7	149,4	92*	104,8	133,4	165,1	102,6	120,7	149,4	181,1	122*	134,9	165,1	196,9			
400								177,8				193,7				193,7			
600								193,8				209,6				209,6			
900	78,74	95,3		168,4				190,5	97,8	117,6	235	206,5				238,1			
1500			174,8					187,5				209,6							
2500		93,2		196,9	XXX														

		5"				6"				8"				10"			
ASA	Øi I.R.	Øi SW	Øe SW	Øe OR	Øi I.R.	Øi SW	Øe SW	Øe OR	Øi I.R.	Øi SW	Øe SW	Øe OR	Øi I.R.	Øi SW	Øe SW	Øe OR	
150	131,8	155,7		196,9	157,3	182,6		222,3	215,9	233,4		279,4	268,3	287,3		339,9	
300				215,9				251			263,7	308,1			317,5	362	
400				212,9				247,7	205,8	225,6		304,8	255,3	274,6		358,9	
600	128,3	147,6	177,8	241,3	154,9	174,8	209,6	266,7				320,8				400,1	
900				247,7				289,1		222,3		358,9		276,4	311,2		
1500				254	147,3	171,5		282,7	196,9		257,3	352,6	246,2	266,7		435,1	
2500	124,5	143		279,4				317,5		215,9		387,4		270		476,3	

		12"				14"				16"				18"			
ASA	Øi I.R.	Øi SW	Øe SW	Øe OR	Øi I.R.	Øi SW	Øe SW	Øe OR	Øi I.R.	Øi SW	Øe SW	Øe OR	Øi I.R.	Øi SW	Øe SW	Øe OR	
150	317,5	339,9	374,7	409,7	349,3	371,6	406,4	450,9	400,1	422,4		514,4	449,3	474,7		549,4	
300				422,4				485,9			463,6	539,8			527,1	596,9	
400		327,2		419,1	342,9	362		482,6	389,9			536,7	438,2	469,9		593,9	
600	307,4			457,2				492,6		412,8		564,2				612,9	
900		323,9		498,6	320,8	355,6		520,7	374,7		457,2	574,8	425,5	463,6	520,7	638,3	
1500	292,1		368,3	520,7		362	400,1	577,9	368,3	406,4		641,4				704,9	
2500		317,5		549,4	XXX					XXX				XXX			

		20"				24"			
ASA	Øi I.R.	Øi SW	Øe SW	Øe OR	Øi I.R.	Øi SW	Øe SW	Øe OR	
150	500,1	525,5	577,9	606,6	603,3	628,7	685,8	717,6	
300				654,1				774,7	
400	489	520,7		647,7	590,6			768,4	
600				682,8				790,7	
900	482,6		571,5	698,8				832,2	
1500	476,3	514,4		755,7	577,9	616	679,5	901,7	

DIMENSIONAL DATA STYLE GR AND GRI TO ASME B16.20 TO SUIT ASME B16.47 SERIES A FLANGES

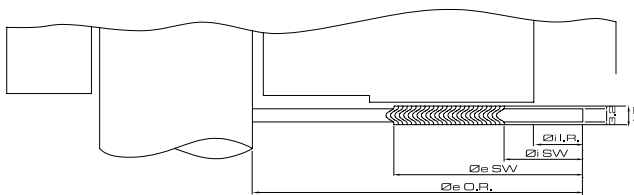

	22"				26"				28"				30"				
ASA	Øi I.R.	Øi SW	Øe SW	Øe OR	Øi I.R.	Øi SW	Øe SW	Øe OR	Øi I.R.	Øi SW	Øe SW	Øe OR	Øi I.R.	Øi SW	Øe SW	Øe OR	
150			610	660,4	654,1	673,1	704,9	774,7			723,9	755,6	831,9		774,7	806,5	882,6
300	X	577,9		704,8				830	704,9				898,6				952,5
400	X		628,7	701,7	660,4	685,8	736,5	831,9	711,2	736,6	787,4	892,2	755,7	793,8	844,5	946,1	
600	X		733,4	647,7	866,8			698,5	911,4								
900		XXX			666,8		882,6	711,2			946,1	774,7				1008,9	

	32"				34"				36"				38"			
ASA	Øi I.R.	Øi SW	Øe SW	Øe OR	Øi I.R.	Øi SW	Øe SW	Øe OR	Øi I.R.	Øi SW	Øe SW	Øe OR	Øi I.R.	Øi SW	Øe SW	Øe OR
150	806,5	825,5	860,6	939,8	857,3	876,3	911,3	990,6	908,1	927,1	968,3	1047,7	958,9	977,9	1019	1111,2
300				1000,1				1057,2				1117,6			1016	1054,1
400				1003				1054		955,7	1006,5		952,5	971,6	1022,3	1073,1
600	812,8	850,9	901,7	1022	863,6	901,7	952,5	1073	917,6			1130,3	990,6	1041,4	1104,9	
900				1028,6				1136,6	920,8	958,9	1010	1200,1	1009,7	1035	1086	1200,1

	40"				42"				44"				46"			
ASA	Øi I.R.	Øi SW	Øe SW	Øe OR	Øi I.R.	Øi SW	Øe SW	Øe OR	Øi I.R.	Øi SW	Øe SW	Øe OR	Øi I.R.	Øi SW	Øe SW	Øe OR
150	1009,7	1028,7	1070	1162	1060,5	1079,5	1124	1219,2	1111,3		1180	1276,3	1162	1181	1229	1327
300	1003,3	1022,4		1114,4	1054,1	1073,2	1121	1165,2	1105	1130,3		1219,2	1153	1178		1273
400	1000,2	1025,5	1076,3	1127,1	1051	1076,4	1127	1177,9			1181,1	1231,9	1168,5	1194	1244,6	1289
600	1009,7	1047,7	1098,5	1155,7	1066,8	1105	1155,7	1219,2	1111,3	1162	1212,8	1270	1162	1213	1263,7	1327
900	1060,5	1098,5	1149,3	1250,9	1111,3	1149,3	1200,1	1301,7	1155,7	1206,5	1257,3	1368,4	1219,2	1270	1321	1435

	48"				50"				52"				54"			
ASA	Øi I.R.	Øi SW	Øe SW	Øe OR	Øi I.R.	Øi SW	Øe SW	Øe OR	Øi I.R.	Øi SW	Øe SW	Øe OR	Øi I.R.	Øi SW	Øe SW	Øe OR
150	1213	1232	1279,5	1384,3	1263,7	1283	1333,5	1435	1314,5	1333,5	1384,3	1492,3	1359	1384,3	1435	1549,4
300	1209,7	1235	1286	1324	1244,6			1378	1321			1428,8				1492,2
400	1206,5	1244,6	1295,4	1346,2	1257,3	1295,4	1346,2	1403	1308	1346	1397	1454,2	1352,6	1403,4	1454,2	1517,6
600	1219,2	1270	1321	1390,6	1270	1321	1371,6	1447,8	1321	1371,6	1422,4	1498,6	1378	1428,8	1479,6	1555,7
900	1270	1321	1371,6	1486	XXX				XXX				XXX			

	56"				58"				60"			
ASA	Øi I.R.	Øi SW	Øe SW	Øe OR	Øi I.R.	Øi SW	Øe SW	Øe OR	Øi I.R.	Øi SW	Øe SW	Øe OR
150	1409,7	1435,1	1486	1606,5	1460,5	1486	1536,7	1663,7	1511,3	1536,7	1587,5	1714,5
300			1505	1543	1447,8	1511,3	1562	1593,9	1524	1562,1	1612,9	1644,6
400	1403,4	1454,2		1568,4	1454,1	1505	1555,7	1619,2	1517,6	1568,4	1619,2	1682,7
600	1428,8	1479,6	1530,3	1612,9	1473,2	1536,7	1587,5	1663,7	1530,3	1593,8	1644,6	1733,5
900	XXX				XXX				XXX			

DIMENSIONAL DATA STYLE GR AND GRI TO ASME B16.20 TO SUIT ASME B16.47 SERIES B FLANGES

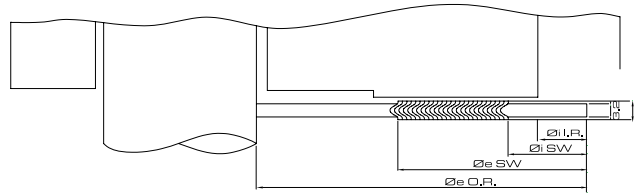

	26"				28"				30"				32"										
ASA	\varnothing I.R.	\varnothing I SW	\varnothing e SW	\varnothing e OR	\varnothing I.R.	\varnothing I SW	\varnothing e SW	\varnothing e OR	\varnothing I.R.	\varnothing I SW	\varnothing e SW	\varnothing e OR	\varnothing I.R.	\varnothing I SW	\varnothing e SW	\varnothing e OR							
75	XXX	666,8	658,8	708,03	XXX	717,55	739,78	758,83	XXX	768,35	790,58	809,63	XXX	819,15	841,38	860,43							
150	654,1	673,1	698,5	725,5	704,9	723,9	749,3	776,29	755,65	774,7	800,1	827,09	806,45	825,5	850,9	881,06							
300			711,2	771,5			762	825,5			812,8	885,82			863,6	939,8							
400	644,5	666,8	698,5	746,15	701,7	714,38	749,3	800,1	752,47	765,18	797,15	857,25	800,1	812,8	860,43	911,23							
600			714,4	765,18	692,2	704,85	755,65	819,15									777,88	828,68	879,47	793,75	831,85	882,65	933,45
900			749,3	838,2	723,9	742,95	800,1	901,7									787,4	806,4	857,25	958,85	838,2	863,6	914,4

	34"				36"				38"				40"											
ASA	\varnothing I.R.	\varnothing I SW	\varnothing e SW	\varnothing e OR	\varnothing I.R.	\varnothing I SW	\varnothing e SW	\varnothing e OR	\varnothing I.R.	\varnothing I SW	\varnothing e SW	\varnothing e OR	\varnothing I.R.	\varnothing I SW	\varnothing e SW	\varnothing e OR								
75	XXX	869,95	892,18	911,23	XXX	920,75	946,15	973,14	XXX				XXX											
150	857,25	876,3	908,05	935,04	908,05	927,1	958,85	987,43	958,85	974,74	1009,7	1044,6	1009,7	1022,4	1063,6	1095,4								
300			914,4	993,78			965,2	1047,8									971,55	1009,7	1047,8	1098,6	1022,3	1060,5	1098,6	1149,4
400	850,9	866,78	911,23	962,03	898,53	917,58	965,2	1022,4	952,5	971,55	1022,4	1073,2	1000,1	1025,5	1076,3	1127,1								
600			939,8	996,95	901,7	939,8		990,6									1047,8	990,6	1041,4	1104,9	1009,7	1047,8	1098,6	1155,7
900			968,38	1073,2	927,1	946,15		996,65									1124	1009,7	1035,1	1085,9	1200,2	1060,5	1098,6	1149,4

	42"				44"				46"				48"			
ASA	\varnothing I.R.	\varnothing I SW	\varnothing e SW	\varnothing e OR	\varnothing I.R.	\varnothing I SW	\varnothing e SW	\varnothing e OR	\varnothing I.R.	\varnothing I SW	\varnothing e SW	\varnothing e OR	\varnothing I.R.	\varnothing I SW	\varnothing e SW	\varnothing e OR
75	XXX	1073,2	1098,6	1125,5	XXX				XXX				XXX	1228,7	1257,3	1282,7
150	1060,4	1079,5	1114,4	1146,2	1111,2	1124	1165,2	1193,8	1162,1	1181,1	1224	1255,7	1212,9	1231,9	1270	1306,5
300	1054,1	1111,3	1149,4	1200,2	1124	1162,1	1200,2	1251	1177,9	1216	1254,1	1317,6	1231,9	1306,5	1311,3	1368,2
400	1050,9	1076,3	1127,1	1177,9	1104,9	1130,3	1181,1	1231,9	1168,4	1193,8	1244,6	1289,1	1206,5	1244,6	1295,4	1346,2
600	1066,8	1104,9	1155,7	1219,2	1111,2	1162,1	1212,9	1270	1162,1	1212,9	1263,7	1327,2	1219,2	1270	1320,8	1390,7
900	1111,2	1149,4	1200,2	1301,8	1155,7	1206,5	1257,3	1368,4	1219,2	1270	1320,8	1435,1	1270	1320,8	1371,6	1485,9

	50"				52"				54"				56"			
ASA	\varnothing I.R.	\varnothing I SW	\varnothing e SW	\varnothing e OR	\varnothing I.R.	\varnothing I SW	\varnothing e SW	\varnothing e OR	\varnothing I.R.	\varnothing I SW	\varnothing e SW	\varnothing e OR	\varnothing I.R.	\varnothing I SW	\varnothing e SW	\varnothing e OR
75	XXX				XXX				XXX	1381,1	1412,9	1438,3	XXX			
150	1263,7	1282,7	1325,6	1357,3	1314,5	1333,5	1376,4	1408,1	1360	1384,3	1422,4	1463,7	1422,4	1444,6	1478	1514,5
300	1266,8	1317,6	1355,7	1419,2	1317,6	1368,4	1406,5	1470					1530,4	1428,8	1479,6	1524
400	1257,3	1295,4	1346,2	1403,4	1308,1	1346,2	1397	1454,2	1352,6	1403,4	1454,2	1517,7	1403,4	1454,2	1505	1568,5
600	1270	1320,8	1371,6	1447,8	1320,8	1371,6	1422,4	1498,6	1378	1428,8	1479,6	1555,8	1428,8	1479,6	1530,4	1612,9
900	XXX				XXX				XXX				XXX			

	58"				60"			
ASA	\varnothing I.R.	\varnothing I SW	\varnothing e SW	\varnothing e OR	\varnothing I.R.	\varnothing I SW	\varnothing e SW	\varnothing e OR
75	XXX				XXX	1536,7	1568,5	1597
150	1478	1500,2	1528,8	1579,6	1535,1	1557,3	1585,9	1630,4
300	1484,3	1535,1	1573,2	1655,8	1557,3	1585,9	1630,4	1706,6
400	1454,2	1504,9	1555,8	1619,3	1517,7	1568,5	1619,3	1682,8
600	1473,2	1536,7	1587,5	1663,7	1530,4	1593,9	1644,7	1733,6
900	XXX				XXX			

DIMENSIONAL DATA STYLE GR AND GRI TO SUIT DIN FLANGES

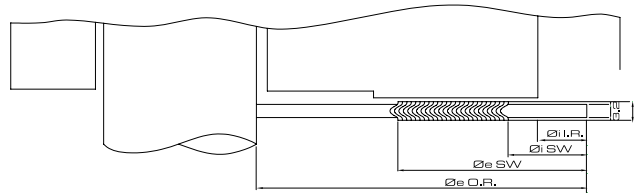

PN	DN 10				DN 15				DN 20				DN 25			
	$\varnothing i$ I.R.	$\varnothing i$ SW	$\varnothing e$ SW	$\varnothing e$ OR	$\varnothing i$ I.R.	$\varnothing i$ SW	$\varnothing e$ SW	$\varnothing e$ OR	$\varnothing i$ I.R.	$\varnothing i$ SW	$\varnothing e$ SW	$\varnothing e$ OR	$\varnothing i$ I.R.	$\varnothing i$ SW	$\varnothing e$ SW	$\varnothing e$ OR
10	18	24	36	46	24	30	42	51	27	33	47	61	34	40	54	71
16				61												
25				72												
40				72												
64				72												
100				72												
160				72												
250	72															
320																

PN	DN 32				DN 40				DN 50				DN 65			
	$\varnothing i$ I.R.	$\varnothing i$ SW	$\varnothing e$ SW	$\varnothing e$ OR	$\varnothing i$ I.R.	$\varnothing i$ SW	$\varnothing e$ SW	$\varnothing e$ OR	$\varnothing i$ I.R.	$\varnothing i$ SW	$\varnothing e$ SW	$\varnothing e$ OR	$\varnothing i$ I.R.	$\varnothing i$ SW	$\varnothing e$ SW	$\varnothing e$ OR
10	44	50	66	82	51	57	73	92	59	69	87	107	73	83	103	127
16				113				138								
25				119				144								
40				124				154								
64				124				170								
100				124				184								
160				124				194								
250	124	204														
320															104	170

PN	DN 80				DN 100				DN 125				DN 150			
	$\varnothing i$ I.R.	$\varnothing i$ SW	$\varnothing e$ SW	$\varnothing e$ OR	$\varnothing i$ I.R.	$\varnothing i$ SW	$\varnothing e$ SW	$\varnothing e$ OR	$\varnothing i$ I.R.	$\varnothing i$ SW	$\varnothing e$ SW	$\varnothing e$ OR	$\varnothing i$ I.R.	$\varnothing i$ SW	$\varnothing e$ SW	$\varnothing e$ OR
10	87	97	121	142	114	124	148	162	140	150	176	192	168	178	204	217
16				168				224								
25				174				247								
40				180				257								
64				184				267								
100				188				277								
160				192				287								
250	196	297														
320	199	307														

PN	DN 175				DN 200				DN 250				DN 300			
	$\varnothing i$ I.R.	$\varnothing i$ SW	$\varnothing e$ SW	$\varnothing e$ OR	$\varnothing i$ I.R.	$\varnothing i$ SW	$\varnothing e$ SW	$\varnothing e$ OR	$\varnothing i$ I.R.	$\varnothing i$ SW	$\varnothing e$ SW	$\varnothing e$ OR	$\varnothing i$ I.R.	$\varnothing i$ SW	$\varnothing e$ SW	$\varnothing e$ OR
10	189	199	225	247	220	230	256	272	269	279	315	327	319	329	365	377
16				284				400								
25				290				417								
40				296				424								
64				302				431								
100				308				438								
160				314				445								
250	320	452														

PN	DN 350				DN 400				DN 500				DN 600			
	$\varnothing i$ I.R.	$\varnothing i$ SW	$\varnothing e$ SW	$\varnothing e$ OR	$\varnothing i$ I.R.	$\varnothing i$ SW	$\varnothing e$ SW	$\varnothing e$ OR	$\varnothing i$ I.R.	$\varnothing i$ SW	$\varnothing e$ SW	$\varnothing e$ OR	$\varnothing i$ I.R.	$\varnothing i$ SW	$\varnothing e$ SW	$\varnothing e$ OR
10	365	375	405	437	416	426	458	488	520	530	566	593	615	630	666	695
16				443				734								
25				449				741								
40				455				748								
64				461				755								
100				467				762								
160				473				769								
250	479	776														
320	485	783														
360	491	790														
400	497	797														
450	503	804														
500	509	811														
550	515	818														
600	521	825														
650	527	832														
700	533	839														
750	539	846														
800	545	853														
850	551	860														
900	557	867														
950	563	874														
1000	569	881														
1050	575	888														
1100	581	895														
1150	587	902														
1200	593	909														
1250	599	916														
1300	605	923														
1350	611	930														
1400	617	937														
1450	623	944														
1500	629	951														
1550	635	958														
1600	641	965														
1650	647	972														
1700	653	979														
1750	659	986														
1800	665	993														
1850	671	1000														
1900	677	1007														
1950	683	1014														
2000	689	1021														
2050	695	1028														
2100	701	1035														
2150	707	1042														
2200	713	1049														
2250	719	1056														
2300	725	1063														
2350	731	1070														
2400	737	1077														
2450	743	1084														
2500	749	1091														
2550	755	1098														
2600	761	1105														
2650	767	1112														
2700	773	1119														
2750	779	1126														
2800	785	1133														
2850	791	1140														
2900	797	1147														
2950	803	1154														
3000	809	1161														
3050	815	1168														
3100	821	1175														
3150	827	1182														
3200	833	1189														
3250	839	1196														
3300	845	1203														
3350	851	1210														
3400	857	1217														
3450	863	1224														
3500	869	1231														
3550	875	1238														
3600	881	1245														
3650	887	1252														
3700	893	1259														
3750	899	1266														
3800	905	1273														
3850	911	1280														
3900	917	1287														
3950	923	1294														
4000	929	1301														
4050	935	1308														
4100	941	1315														
4150	947	1322														
4200	953	1329														
4250	959	1336														
4300	965	1343														
4350	971	1350														
4400	977	1357														
4450	983	1364														
4500	989	1371														
4550	995	1378														
4600	1001	1385														
4650	1007	1392														
4700	1013	1399														
4750	1019	1406														
4800	1025	1413														
4850	1031	1420														
4900	1037	1427														
4950	1043	1434														
5000	1049	1441														
5050	1055	1448														
5100	1061	1455														
5150	1067	1462														
5200	1073	1469														
5250	1079	1476														
5300	1085	1483														
5350	1091	1490														
5400	1097	1497														
5450	1103	1504														
5500	1109	1511														
5550	1115	1518														
5600	1121	1525														
5650	1127	1532														
5700	1133	1539														
5750	1139	1546														
5800	1145	1553														
5850	1151	1560														
5900	1157	1567														
5950	1163	1574														
6000	1169	1581														
6050	1175	1588														
6100	1181	1595														
6150	1187	1602														
6200	1193	1609														
6250	1199	1616														
6300	1205	1623														
6350	1211	1630														
6400	1217	1637														
6450	1223	1644														
6500	1229	1651														
6550	1235	1658														
6600	1241	1665														
6650	1247	1672														
6700	1253	1679														
6750	1259	1686														
6800	1265	1693														
6850	1271	1700														
6900	1277	1707														
6950	1283	1714														
7000	1289	1721														
7050	1295	1728														
7100	1301	1735														
7150	1307	1742														
7200	1313	1749														
7250	1319	1756														
7300	1325	1763														
7350	1331	1770														
7400	1337	1777														
7450	1343	1784														
7500	1349	1791														
7550	1355	1798														
7600	1361	1805														
7650	1367	1812														
7700	1373	1819														
7750	1379	1826														
7800	1385	1833														
7850	1391	1840														
7900	1397	1847														
7950	1403	1854														
8000	1409	1861														
8050	1415	1868														
8100	1421	1875														
8150	1427	1882														
8200	1433	1889														
8250	1439	1896														
8300	1445	1903														
8350	1451	1910														
8400	1457	1917														
8450	1463	1924														
8500	1469	1931														
8550	1475	1938														
8600	1481	1945														
8650	1487	1952														
8700	1493	1959														
8750	1499	1966														
8800	1505	1973														
8850	1511	1980														
8900	1517	1987														
8950	1523	1994														
9000	1529	2001														
9050	1535	2008														
9100	1541	2015														
9150	1547	2022														
9200	1553	2029														
9250	1559	2036														
9300	1565	2043														
9350	1571	2050														
9400	1577	2057														
9450	1583	2064														
9500	1589	2071														
9550	1595	2078														
9600	1601	2085														
9650	1607	2092														
9700	1613	2099														
9750	1619	2106														
9800	1625	2113														
9850	1631	2120														
9900	1637	2127														
9950	1643	2134														
10000	1649	2141														
10050	1655	2148														
10100	1661	2155														
10150	1667	2162														
10200	1673	2169														
10250	1679	2176														
10300	1685	2183														
10350	1691	2190														
10400	1697	2197														
10450	1703	2204														
10500	1709	2211														
10550	1715	2218														
10600	1721	2225														
10650	1727	2232														
10700	1733	2239														
10750	1739	2246														
10800	1745	2253														
10850	1751	2260														
10900	1757	2267														
10950	1763	2274														
11000	1769	2281														
11050	1775	2288														
11100	1781	2295														
11150	1787	2302														
11200	1793	2309</														

DIMENSIONAL DATA STYLE GR AND GRI TO SUIT DIN FLANGES

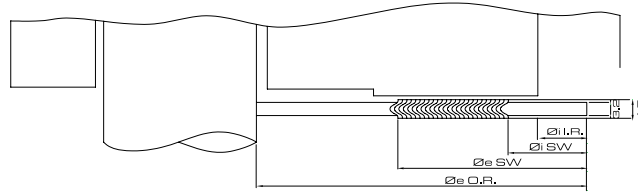

	DN 700				DN 800				DN 900				DN 1000			
ASA	øi I.R.	øi SW	øe SW	øe OR	øi I.R.	øi SW	øe SW	øe OR	øi I.R.	øi SW	øe SW	øe OR	øi I.R.	øi SW	øe SW	øe OR
10	715	730	770	810	815	830	874	917	915	930	974	1017	1015	1030	1078	1124
16				804				911				1011				1128
25				833				942				1042				1154
40				852				974				1084				1194
64			778	879				882				988				982

	DN 1200				DN 1400				DN 1600				DN 1800			
ASA	øi I.R.	øi SW	øe SW	øe OR	øi I.R.	øi SW	øe SW	øe OR	øi I.R.	øi SW	øe SW	øe OR	øi I.R.	øi SW	øe SW	øe OR
10	1210	1230	1280	1341	1420	1450	1510		1630	1660	1720	1764	1830	1860	1920	1964
16				1342								1798				2000
25				1364								1830				
40				1398								R-RIR				
64			1290	1452			1548	R-RIR			1772	R-RIR			1972	R-RIR

	DN 2000				DN 2200				DN 2400				DN 2600					
ASA	øi I.R.	øi SW	øe SW	øe OR	øi I.R.	øi SW	øe SW	øe OR	øi I.R.	øi SW	øe SW	øe OR	øi I.R.	øi SW	øe SW	øe OR		
10	2030	2060	2120	2168	2230	2260	2330	2378	2430	2460	2530	R-RIR	2630	2660	2730	R-RIR		
16				2230														
25																		
40																		
64			2182	R-RIR			2384	R-RIR			2594						2794	

	DN 2800				DN 3000						
ASA	øi I.R.	øi SW	øe SW	øe OR	øi I.R.	øi SW	øe SW	øe OR			
10	2830	2860	2930	R-RIR	3030	3060	3130	R-RIR			
16											
25											
40											
64			3014						3228		

SPIRAL WOUND GASKET

FLEXWOUND® BS low stress spiral wound gaskets

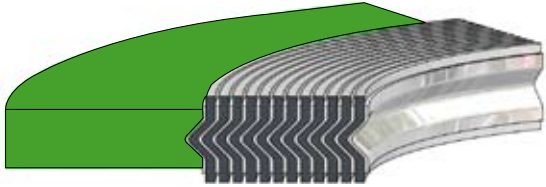

The BS and BSI gaskets are specifically designed to be used in those applications where a low bolt torque is required. Traditional spiral wound gaskets have the steel winding protruding above the compression stop. BS and BSI gaskets instead have the filler material protruding above the metal winding and the guide ring. This results in a perfect sealability achieved with a lower loading stress compared to traditional spiral wound gaskets.

FLEXWOUND® HT high temperature spiral wound gaskets

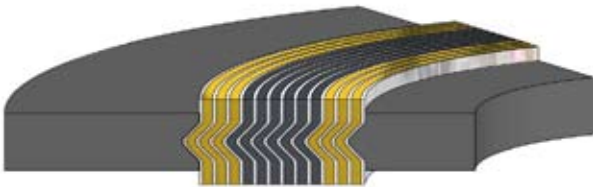

The HT gaskets are specifically designed to be used at extreme temperatures and in presence of oxidizing environments. The construction includes special HT Inconel X750 windings and rings combined with Flexigraf® filler protected on inside and outside diameter by a heat and oxidation resistant Micatherm filler.

up to

1.000°C

FOR SPECIAL APPLICATION

FLEXWOUND® NOSE-RI heat exchanger spiral wound gaskets

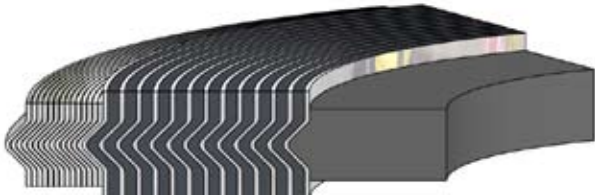

NOSE RI Gaskets with spiral wound outer ring are primarily designed for TEMA male and female flanges and are custom built to suit the design conditions of individual heat exchanger vessels. These gaskets are available in an extensive range of materials. The external nose ensures the correct location of the spiral wound sealing element which is protect by an internal ring, used also as a compression stop. Nose RI gaskets are available also with solid metal or metal jacketed pass bar configuration.

FLEXWOUND® CARRIER GASKETS



CARRIER gaskets consist of a solid steel ring with machined recess in each faces where spiral wound gaskets are located. This results in a higher recovery gasket which ensure that the bolt torque is maintained even in presence of hard pressure and temperature cycles. Typical applications are power genertion, petrochemical and nuclear industries. Carrier gaskets can be used on flat face, raised face or tongue and groove type flange, as well as non standard flange configurations. They can be supplied for both small and large diameter nominal bores up to class 2500 pressure rating. Carrier gaskets are also tailor made to suit specific flange arrangements and design conditions.

MULTI-CLASS GASKET CONFIGURATION



One gasket accommodates both Class 150 and 300 flanges. Multi-Class Gasket features are as follows:

- One gasket accommodates both Class 150 and 300 flanges, available pipe size 1/2" – 24" (Class 150 to 600 in NPS 1/2 through NPS 3).
- Reduced inventory requirements.
- Easy to install: less than half the studs need to be removed to change the gasket.

FLEXCAMM® CAMMPROFILE GASKETS

FMI Flexcamm® cammprofile gaskets are recognized as a new high quality sealing alternative. These gaskets are used as problem solver when there is a difficult sealing environment and performance are critical at low seating stresses. Flexcamm® gaskets consist of a metal core with concentric grooves with sealing layers made of flexible graphite Flexigraf®, expanded mica Micatherm, conventional ptfе or bidirectional ptfе Sicheм®. Metal core is usually selected based on metallurgy of the piping. Flexcamm® are manufactured in different materials and non-circular shapes with extreme accuracy. They can also be custom engineered to fit various applications.

STYLE FN

Manufactured without a guide ring for tongue and groove, or recessed flange applications such as male and female. It is typically used in heat exchanger applications and applied as an upgrade to double jacketed gaskets.



STYLE FG

Constructed with an integral guide ring for aligning purposes. It is suggested to be used in raised face flanges. The gasket is typically designed and sized per EN12560-6 spec for ASME B16.5 flanges, but can be manufactured to fit other standards.



STYLE FA

Constructed with a loose guide ring. This solution is recommended in application with excessive radial shear characteristics, thermal cycling, and expansions. The gasket is typically designed and sized per EN12560-6 spec for ASME B16.5 flanges, but can be manufactured to fit other standards.



SRG GASKET (solid reinforced graphite)

SRG gasket is a solid gasket made by a rigid metal core with two expanded graphite layers bonded to each face. Solid core provide protection against blow out whilst soft graphite layers provide an excellent seal due its high conformability into the flange faces even under low applied seating stresses. It is possible to use a wide range of core materials, from carbon steel to exotic alloys. SRG gasket finds applications in chemical and petrolchemical plants for Low pressure heat exchangers, narrow land width, non circular shapes.



DIMENSIONAL DATA TO SUIT RAISED FACED EN 12560-6 FLANGES FROM DN 10 TO 1400 mm

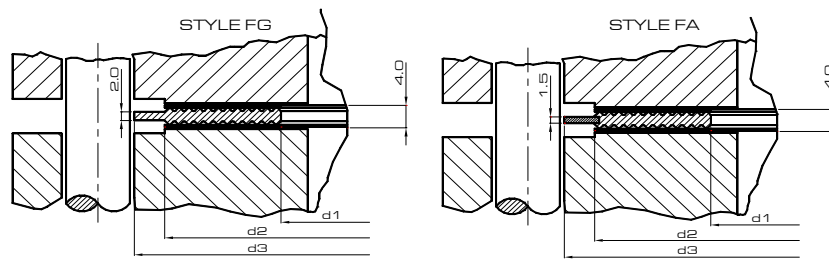

SIZE mm			10	16	25	40	64	100	160	250	320	400
DN	d1	d2	d3	d3	d3	d3	d3	d3	d3	d3	d3	d3
10	22	36	46	46	46	46	56	56	56	67	67	67
15	26	42	51	51	51	51	61	61	61	72	72	78
20	31	47	61	61	61	61	-	-	-	-	-	-
25	36	52	71	71	71	71	82	82	82	82	92	104
32	46	66	82	82	82	82	-	-	-	-	-	-
40	53	73	92	92	92	92	103	103	103	109	119	135
50	65	87	107	107	107	107	113	119	119	124	134	150
65	81	103	127	127	127	127	137	143	143	153	170	192
80	95	121	142	142	142	142	148	154	154	170	190	207
100	118	144	162	162	168	168	174	180	180	202	229	256
125	142	176	192	192	194	194	210	217	217	242	274	301
150	170	204	217	217	224	224	247	257	257	284	311	348
175	195	229	247	247	254	265	277	287	284	316	358	402
200	224	258	272	272	284	290	309	324	324	358	398	442
250	275	315	327	328	340	352	364	391	388	442	488	-
300	325	365	377	383	400	417	424	458	458	536	-	-
350	375	420	437	443	457	474	486	512	-	-	-	-
400	426	474	489	495	514	546	543	572	-	-	-	-
450	480	528	539	555	-	571	-	-	-	-	-	-
500	530	578	594	617	624	628	657	704	-	-	-	-
600	630	680	695	734	731	747	764	813	-	-	-	-
700	730	780	810	804	833	852	879	950	-	-	-	-
800	830	880	917	911	942	974	988	-	-	-	-	-
900	930	980	1017	1011	1042	1084	1108	-	-	-	-	-
1000	1040	1090	1124	1128	1154	1194	1220	-	-	-	-	-
1200	1250	1310	1341	1342	1364	1398	1452	-	-	-	-	-
1400	1440	1510	1548	1542	1578	1618	-	-	-	-	-	-

DIMENSIONAL DATA TO SUIT RAISED FACED ASME B16.5 AND MSS SP44 FLANGES

SIZE mm			150	300	400	600	900	1500	2500
DN	d1	d2	d3	d3	d3	d3	d3	d3	d3
1/2	23,0	33,3	44,4	50,8	50,8	50,8	60,3	60,3	66,7
3/4	28,6	39,7	53,9	63,5	63,5	63,5	66,7	6,7	73,0
1	36,5	47,6	63,5	69,8	69,8	69,8	76,2	76,2	82,5
1 1/4	44,4	60,3	73,0	79,4	79,4	79,4	85,7	85,7	101,6
1 1/2	52,4	69,8	82,5	92,1	92,1	92,1	95,2	95,2	114,3
2	69,8	88,9	101,6	108,0	108,0	108,0	139,7	139,7	142,8
2 1/2	82,5	101,6	120,6	127,0	127,0	127,0	161,9	161,9	165,1
3	98,4	123,8	133,4	146,1	146,1	146,1	165,1	171,5	193,7
3 1/2	111,1	136,5	158,8	161,9	158,7	158,7	-	-	-
4	123,8	154,0	171,5	177,8	174,6	190,5	203,2	206,4	231,7
5	150,8	182,6	193,7	212,7	209,5	238,1	244,5	250,8	276,2
6	177,8	212,7	219,1	247,7	244,5	263,5	285,8	279,4	314,3
8	228,6	266,7	276,2	304,8	301,6	317,5	355,6	349,3	384,1
10	282,6	320,7	336,5	358,8	355,6	396,9	431,8	431,8	473,0
12	339,7	377,8	406,4	419,1	415,9	454,0	495,3	517,5	546,1
14	371,5	409,6	447,7	482,6	479,4	488,9	517,5	574,7	-
16	422,3	466,7	511,2	536,6	533,4	561,9	571,5	638,1	-
18	479,4	530,2	546,1	593,7	590,5	609,6	635,0	701,7	-
20	530,2	581,0	603,2	650,9	644,5	679,5	695,3	752,4	-
22	581,0	631,8	657,2	701,7	698,5	730,3	-	-	-
24	631,8	682,6	714,4	771,5	765,2	787,4	835,0	898,5	-

SIZE mm			150	300	400	600	900
DN	d1	d2	d3	d3	d3	d3	d3
26	690	740	772	832	829	864	880
28	740	790	829	895	889	911	943
30	800	850	880	949	943	968	1007
32	845	905	937	1003	1000	1019	1070
34	895	955	987	1054	1051	1070	1134
36	950	1010	1045	1114	1114	1127	1197
38	960	1020	1108	1051	1070	1102	1197
40	1015	1075	1159	1111	1124	1153	1248
42	1065	1125	1216	1162	1175	1216	1299
44	1125	1185	1273	1216	1229	1267	1365
46	1175	1235	1324	1270	1286	1324	1432
48	1220	1290	1381	1321	1343	1388	1483
50	1270	1350	1432	1375	1400	1445	-
52	1320	1400	1489	1426	1451	1495	-
54	1375	1455	1546	1489	1515	1553	-
56	1430	1510	1603	1540	1565	1610	-
58	1485	1565	1661	1591	1616	1661	-
60	1535	1615	1711	1742	1680	1730	-

RING JOINT GASKETS

RTJ gaskets are produced in different solid metal types. They are used for high pressure (till 1300 bar) and for high temperature (till 1000°C) and are used where corrosive agents are presents. These gaskets are obtained by meccanical working from forged or laminated metals. RTJ find their mainly application in refining process in crude extraction and in high pressure applications. For their production we use the last edition of the API standard. FMI can supply oval and octagonal ring joint, BX and RX for all applications to suite the flanges design with standard and special styles.

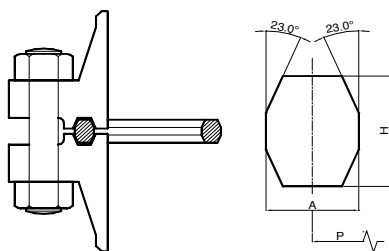

STYLE R - OCTAGONAL

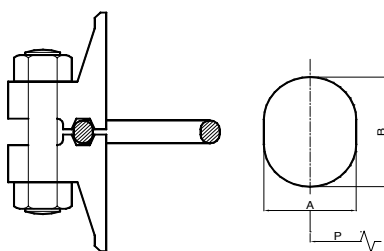

STYLE R - OVAL

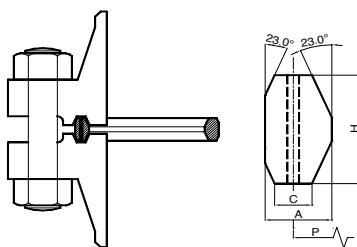

STYLE R X

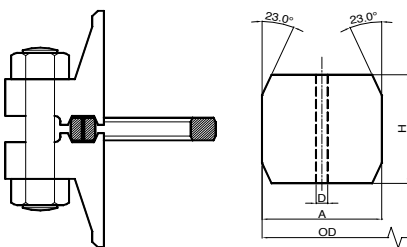

STYLE B X



**DIMENSIONAL DATA TYPE R OCTAGONAL
AND OVAL RING GASKETS TO SUIT ASME B16.20 AND API 6A**

RING. NR.	PRESSURE CLASS RATINGS							PITCH DIAMET. OF RING P	WIDHT OF RING A	HEIGHT OF RING		APPROX. DISTANCE BETWEEN MADE UP FLANGES
	ANSI, BS & MSS					API (p-s.i.)				OVAL B	OCTAG. H	
	150	300/600	900	1500	2500	2000/3000	5000					
	NOMINAL PIPE SIZE											
R11	-	1/2	-	-	-	-	-	1,344	0,250	0,44	0,38	-
R12	-	-	1/2	1/2	-	-	-	1,563	0,313	0,56	0,50	-
R13	-	3/4	-	-	1/2	-	-	1,688	0,313	0,56	0,50	-
R14	-	-	3/4	3/4	-	-	-	1,750	0,313	0,56	0,50	-
R15	1	-	-	-	-	-	-	1,875	0,313	0,56	0,50	-
R16	-	1	1	1	3/4	-	-	2,000	0,313	0,56	0,50	-
R17	1 1/4	-	-	-	-	-	-	2,250	0,313	0,56	0,50	-
R18	-	1 1/4	11/4	11/4	1	-	-	2,375	0,313	0,56	0,50	-
R19	1 1/2	-	-	-	-	-	-	2,563	0,313	0,56	0,50	-
R20*	-	1 1/2	1 1/2	1 1/2	-	-	-	2,688	0,313	0,56	0,50	0,16
R21	-	-	-	-	1 1/4	-	-	2,844	0,438	0,69	0,63	-
R22	2	-	-	-	-	-	-	3,250	0,313	0,56	0,50	-
R23*	-	2	-	-	1 1/2	2 1/16**	-	3,250	0,438	0,69	0,63	0,19
R24*	-	-	2	2	-	2 1/6	2	3,750	0,438	0,69	0,63	0,19
R25	2 1/2	-	-	-	-	-	-	4,000	0,313	0,56	0,50	-
R26*	-	2 1/2	-	-	2	2 9/16	-	4,000	0,438	0,69	0,63	0,19
R27*	-	-	2 1/2	2 1/2	-	(2 9/16)	2 9/16	4,250	0,438	0,69	0,63	0,19
R28	-	-	-	-	2/1/2	-	-	4,375	0,500	0,75	0,69	-
R29	3	-	-	-	-	-	-	4,500	0,313	0,56	0,50	-
R30§	-	3	-	-	-	-	-	4,625	0,438	0,69	0,63	-
R31*	-	3	3	-	-	3 1/8	-	4,875	0,438	0,69	0,63	0,19
R32	-	-	-	-	3	-	-	5,000	0,500	0,75	0,69	-
R33	3 1/2	-	-	-	-	-	-	5,188	0,313	0,56	0,50	-
R34	-	3 1/2	-	-	-	-	-	5,188	0,438	0,69	0,63	-
R35*	-	-	-	3	-	-	3 1/8	5,375	0,438	0,69	0,63	0,19
R36	4	-	-	-	-	-	-	5,875	0,313	0,56	0,50	-
R37*	-	4	4	-	-	4 1/6	-	5,875	0,438	0,69	0,63	0,19
R38	-	-	-	-	4	-	-	6,188	0,625	0,88	0,81	-
R39*	-	-	-	4	-	-	4 1/6	6,375	0,438	0,69	0,63	0,19
R40	5	-	-	-	-	-	-	6,750	0,313	0,56	0,50	-
R41*	-	5	5	-	-	-	-	7,125	0,438	0,69	0,63	0,19
R42	-	-	-	-	5	-	-	7,500	0,750	1,00	0,94	-
R43	6	-	-	-	-	-	-	7,625	0,313	0,56	0,50	-
R44*	-	-	-	5	-	-	-	7,625	0,438	0,69	0,63	0,19
R45*	-	6	6	-	-	7 1/6	-	8,313	0,438	0,69	0,63	0,19
R46*	-	-	-	6	-	-	7 1/6	8,313	0,500	0,75	0,69	0,13
R47*	-	-	-	-	6	-	-	9,000	0,750	1,00	0,94	0,16
R48	8	-	-	-	-	-	-	9,750	0,313	0,56	0,50	-
R49*	-	8	8	-	-	9	-	10,625	0,438	0,69	0,63	0,19
R50*	-	-	-	8	-	-	9	10,625	0,625	0,88	0,81	0,16
R51	-	-	-	-	8	-	-	11,000	0,875	1,13	1,06	-
R52	10	-	-	-	-	-	-	12,000	0,313	0,56	0,50	-
R53*	-	10	10	-	-	11	-	12,750	0,438	0,69	0,63	0,19
R54*	-	-	-	10	-	-	11	12,750	0,625	0,88	0,81	0,16
R55	-	-	-	-	10	-	-	13,500	1,125	1,44	1,38	-
R56	12	-	-	-	-	-	-	15,000	0,313	0,56	0,69	-
R57*	-	12	12	-	-	13 5/8	-	15,000	0,438	0,69	0,63	0,19

**DIMENSIONAL DATA TYPE R OCTAGONAL
AND OVAL RING GASKETS TO SUIT ASME B16.20 AND API 6A**

RING. NR.	PRESSURE CLASS RATINGS							PITCH DIAMET. OF RING P	WIDHT OF RING A	HEIGHT OF RING		APPROX. DISTANCE BETWEEN MADE UP FLANGES
	ANSI, BS & MSS					API (p-s.i.)				OVAL B	OCTAG. H	
	150	300/600	900	1500	2500	2000/3000	5000					
	NOMINAL PIPE SIZE											
R58	-	-	-	12	-	-	-	15,000	0,875	1,13	1,06	-
R59	14	-	-	-	-	-	-	15,625	0,313	0,56	0,50	-
R60	-	-	-	-	12	-	-	16,000	1,250	1,56	1,50	-
R61	-	14	-	-	-	-	-	16,500	0,438	0,69	0,63	-
R62	-	-	14	-	-	-	-	16,500	0,625	0,88	0,81	-
R63*	-	-	-	14	-	-	-	16,500	1,000	1,31	1,25	0,22
R64	16	-	-	-	-	-	-	17,875	0,313	0,56	0,50	-
R65*	-	16	-	-	-	16	3/4**	18,500	0,438	0,69	0,63	0,19
R66*	-	-	16	-	-	(16)	-	18,500	0,625	0,88	0,81	0,16
R67	-	-	-	16	-	-	-	18,500	1,125	1,44	1,38	-
R68	18	-	-	-	-	-	-	20,375	0,313	0,56	0,50	-
R69*	-	18	-	-	-	-	-	21,000	0,438	0,69	0,63	0,19
R70*	-	-	18	-	-	(18)	-	21,000	0,750	1,00	0,94	0,19
R71	-	-	-	18	-	-	-	21,000	1,125	1,44	1,38	-
R72	20	-	-	-	-	-	-	22,000	0,313	0,56	0,50	-
R73*	-	20	-	-	-	21	1/4**	23,000	0,500	0,75	0,69	0,13
R74*	-	-	20	-	-	(20	3/4)	23,000	0,750	1,00	0,94	0,19
R75	-	-	-	20	-	-	-	23,000	1,250	1,56	1,50	-
R76	24	-	-	-	-	-	-	26,500	0,313	0,56	0,50	-
R77	-	24	-	-	-	-	-	27,250	0,625	0,88	0,81	-
R78	-	-	24	-	-	-	-	27,250	1,000	1,31	1,25	-
R79	-	-	-	24	-	-	-	27,250	1,375	1,75	1,63	0,19
R80	22	-	-	-	-	-	-	24,250	0,313	-	0,50	-
R81	-	22	-	-	-	-	-	25,000	0,563	-	0,75	-
R82*	-	-	-	-	-	-	-	2,250	0,438	-	0,63	0,19
R84*	-	-	-	-	-	-	-	2,500	0,438	-	0,63	0,19
R85*	-	-	-	-	-	-	-	3,125	0,500	-	0,69	0,13
R86*	-	-	-	-	-	-	-	3,563	0,625	-	0,81	0,16
R87*	-	-	-	-	-	-	-	3,938	0,625	-	0,81	0,16
R88*	-	-	-	-	-	-	-	4,875	0,750	-	0,94	0,19
R89*	-	-	-	-	-	-	-	4,500	0,750	-	0,94	0,19
R90*	-	-	-	-	-	-	-	6,125	0,875	-	1,06	0,19
R91*	-	-	-	-	-	-	-	10,250	1,250	-	1,50	0,16
R92	-	-	-	-	-	-	-	9,000	0,438	0,69	0,63	-
R93	-	26	-	-	-	-	-	29,500	0,750	-	0,94	-
R94	-	28	-	-	-	-	-	31,500	0,750	-	0,94	-
R95	-	30	-	-	-	-	-	33,750	0,750	-	0,94	-
R96	-	32	-	-	-	-	-	36,000	0,875	-	1,06	-
R97	-	34	-	-	-	-	-	38,000	0,875	-	1,06	-
R98	-	36	-	-	-	-	-	40,125	0,875	-	1,06	-
R99*	-	-	-	-	-	-	-	9,250	0,438	-	0,63	0,19
R100	-	-	26	-	-	-	-	29,500	1,125	-	1,38	-
R101	-	-	28	-	-	-	-	31,500	1,250	-	1,50	-
R102	-	-	30	-	-	-	-	33,750	1,250	-	1,50	-
R103	-	-	32	-	-	-	-	36,000	1,250	-	1,50	-
R104	-	-	34	-	-	-	-	38,000	1,375	-	1,63	-
R105	-	-	36	-	-	-	-	40,250	1,375	-	1,63	-



For a detailed list of the approvals,
please visit our dedicated area on
www.fmi-spa.com/approvals



ITALIAN SEALING SOLUTIONS

Via Consolare, 41/43 25030
Zocco di Erbusco - (BS) ITALY
Tel. +39 030 7386033 - Fax +39 030 7386035
www.fmi-spa.com